

Berea

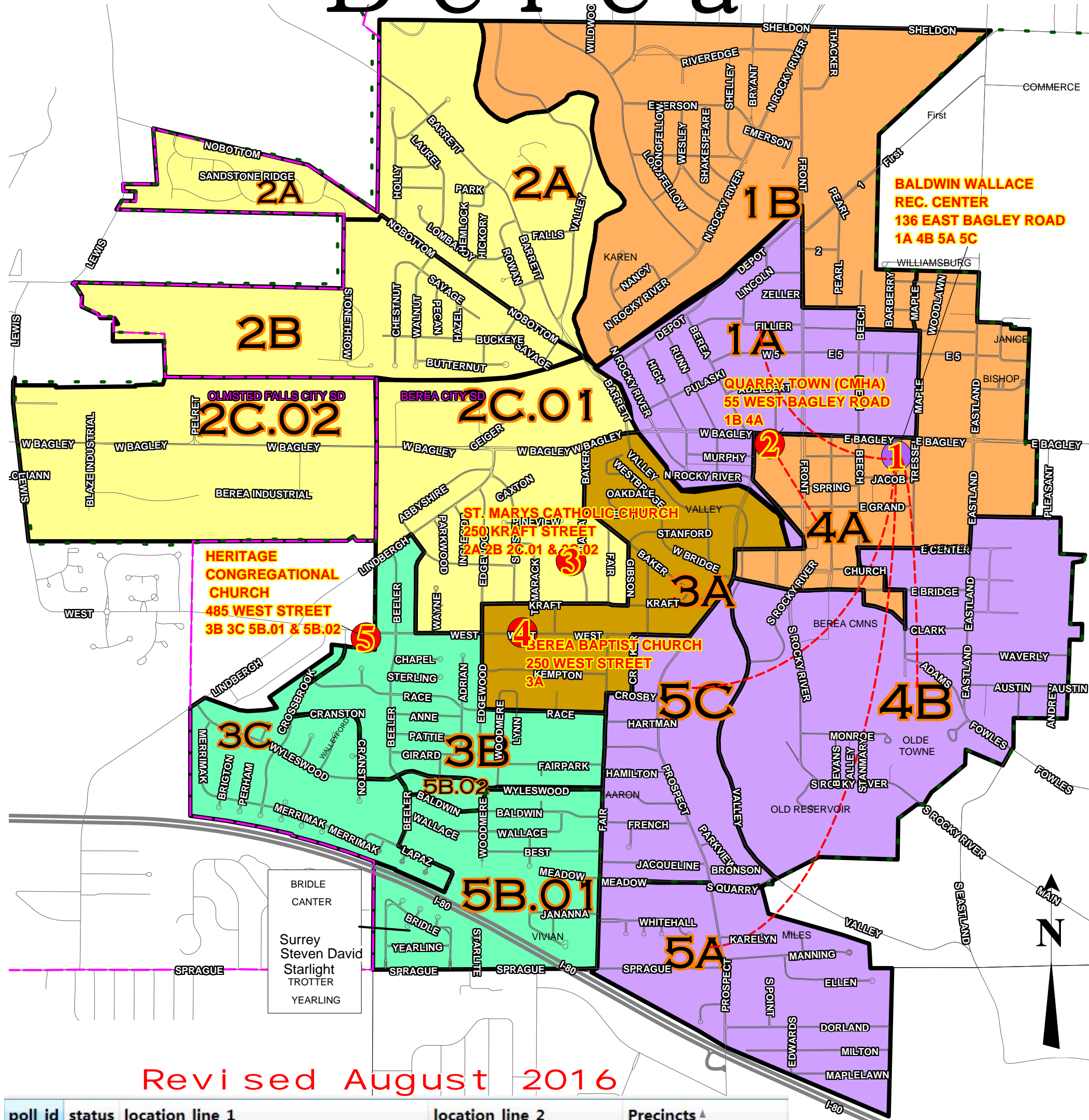

Revised August 2016

| poll_id | status | location_line_1 | location_line_2 | Precincts ^A |
|---------|--------|--------------------------------|----------------------|------------------------|
| 1 | A | BALDWIN WALLACE REC. CENTER | 136 EAST BAGLEY ROAD | 1A 4B 5A 5C |
| 2 | A | QUARRY TOWN (CMHA) | 55 WEST BAGLEY ROAD | 1B 4A * |
| 3 | A | ST. MARYS CATHOLIC CHURCH | 250 KRAFT STREET | 2A 2B 2C.01 & 2C.02 |
| 4 | A | BEREA BAPTIST CHURCH | 250 WEST STREET | 3A |
| 5 | A | HERITAGE CONGREGATIONAL CHURCH | 485 WEST STREET | 3B 3C 5B.01 & 5B.02 |

*Quarry Town Residents
Vote at Quarry Town!

Voting Location by Precinct

- BALDWIN WALLACE REC. CENTER
- BERE A BAPTIST CHURCH
- HERITAGE CONGREGATIONAL CHURCH
- QUARRY TOWN (CMHA)
- ST. MARYS CATHOLIC CHURCH

- Voting Precincts
- U.S. Congressional Boundary
- School District Boundary

Notice to buyer: The Cuyahoga County Board of Elections cannot guarantee the absolute accuracy of the data purchased. The information contained on this map reflects the most recent updates to our records. In the unlikely event that serious data problems are detected, please contact the GIS Technician at (216)443-6686

Prepared by:
Cuyahoga County Board of Elections
August 30, 2016 John Eddy

