

LOCATION SETUP DIAGRAM CLAGUE CABIN

Voting Room: Community Room

REVISED 09/14/18 GJF

3 Precincts Assigned:

WESTLAKE 01-A
WESTLAKE 01-B
WESTLAKE 01-C

Staff and Equipment:





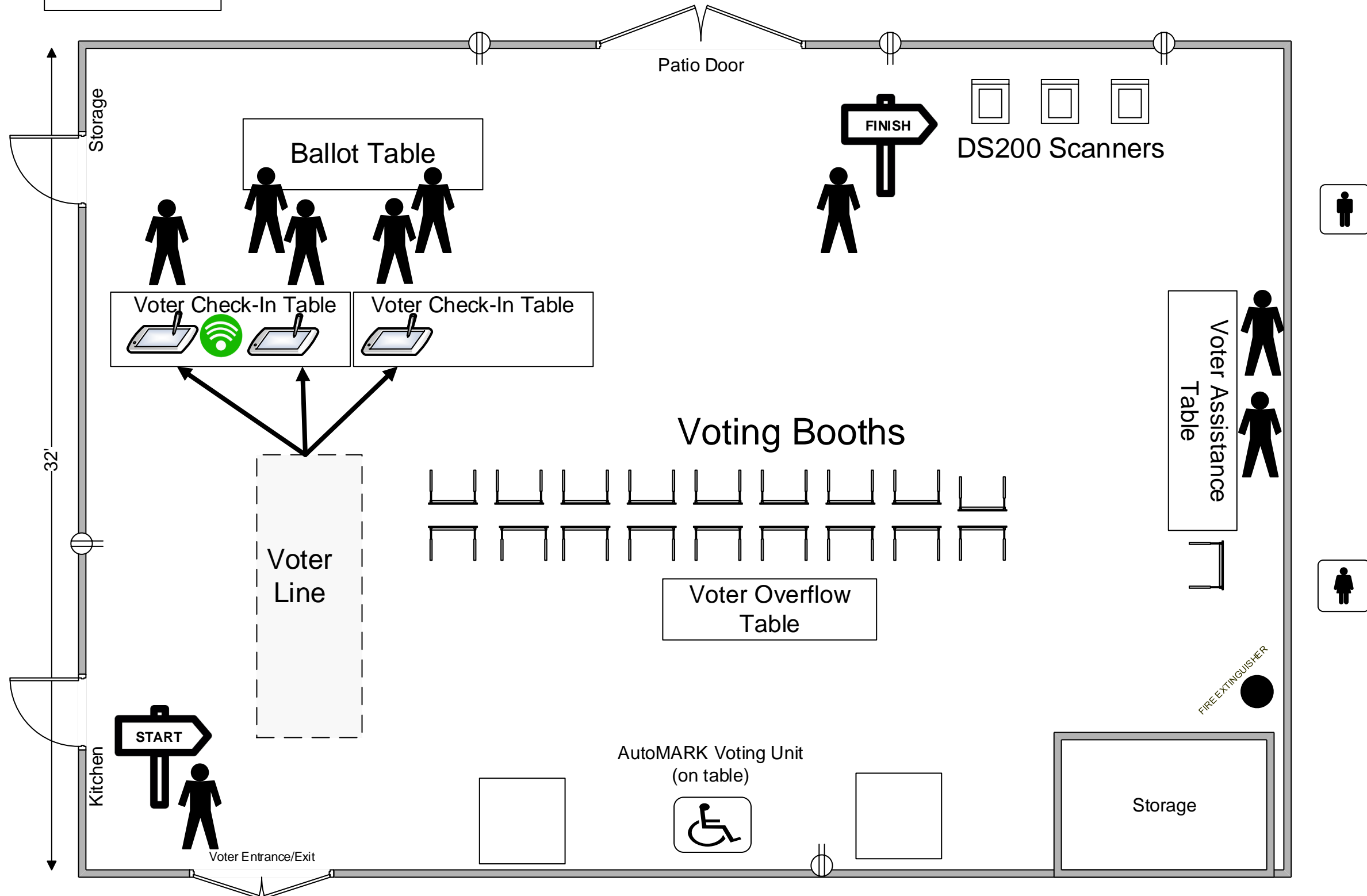

- 12 – Election Officials
- 19 – Voting Booths
- 3 – DS200 Scanners
- 3 – Electronic Pollbooks
- 1 – MiFi Hotspot
- 1 – AutoMARK Voting Unit

Notes:

- You **MUST** follow this diagram as closely possible when setting up your Polling Location.
- Any major changes to the setup of the Polling Location must be approved by the Board of Elections.
- Note any approved setup changes on this diagram and place in the Return Envelope to be turned in Election Night.

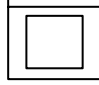

Key:

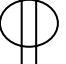
- ELECTION OFFICIAL 
- VOTING BOOTH 
- DS200 SCANNER 
- ELECTRONIC POLLBOOK 
- MiFi HOTSPOT 
- AutoMARK VOTING UNIT 
- ELECTRICAL OUTLET 

ROVER VERIFICATION:

Is the location set up according to this diagram?

_____ YES _____ NO*

*If the location is not set up according to this diagram, please mark changes.

Rover Signature: _____